

Surrounding Councils and Camps

Cimarron Council

An advance permit must be secured from the Council Office.
For camp fees, advance permits or more information contact:

Cimarron Council

PO Box 3146 • 317 N Grand
Enid, OK 73701

Business phone: (580) 234-3652

Fax: (580) 234-3537

Email: council@cimarronbsa.org

Web: www.cimarronbsa.org

Will Rogers Scout Reservation

Location: Five miles West of Cleveland, OK on Highway 64. The camp overlooks the Arkansas River.

Facilities: Pond, rappelling, hiking, shelters, dining hall, shooting ranges, unit weekend camping and Boy Scout “long-term” camp.

Map: See map on page 45.

Indian Nations Council

An advance permit must be secured from the Council Office.
For camp fees, advance permits or more information contact:

Indian Nations Council

3206 S. Peoria
Tulsa, OK 74105

Business phone: (918) 743-6125

Business phone: (800) 367-1272

Email: info@okscouts.org

Web: www.okscouts.org

Camp Fred Darby

Location: Seven miles Southeast of Tahlequah near Welling. The terrain is wooded and rocky, Near the Barren Fork River.

Facilities: Cave exploring, unit camping and C.O.P.E.S.

Map: See map on page 46.

Camp Garland

Location: Two miles South of the Cherokee Turnpike (Highway 412) on Highway 82.

Facilities: Bartlett Training Center, hiking, R.O.P.E.S. and unit camping.

Map: See maps on pages 47 and 48.

Hale Scout Reservation

Location: Follow Highway 10, 0.6 miles North of Highway 63, near Tahlequah, OK.

Facilities: Shooting ranges, pool, dining hall, climbing tower, Boy Scout “long-term” camps, and unit camping.

Map: See maps on pages 49 and 50.

Keystone Scout Camp

Location: From Tulsa take Highway I-244 West, which turns into Highway 64. Exit on State Highway 48 South. Turn West onto Terlton Road. 1 mile on the left is the camp gate.

Facilities: Unit camping, canoe access to Lake Keystone, training center and ponds.

Map: See maps on pages 51 and 52.

Camp Russell/Outer Limits

Location: In Broken Arrow on 101st East of 193rd East Avenue.

Facilities: The Robson Family OuterLimits Center is an experiential-based learning program which includes a variety of team building activities that youth and adults utilize on a year round basis. The OuterLimits Center fosters development in leadership skills, problem solving, communication, trust, teamwork, self-esteem and decision-making. The OuterLimits Center is equipped with 30 high elements and many low team elements designed to meet the goals and objectives of youth as well as corporate teams.

Map: See maps on pages 53 and 54.

John Zink Ranch

Location: From Tulsa take I-244 West – this Highway turns into Highway 64. Exit on Adams Road. Adams Road will take you into Sand Springs. In Sand Springs take a right onto Highway 97 North (McKinley Street). It is 9 miles to the Zink Ranch.

Facilities: Aquatics Sport Center, Family Enrichment Center (Cub World), and Boy Scout unit camping.

Map: See maps on pages 55 and 56.

Quivira Council

An advance permit must be secured from the Council Office.
For camp fees, advance permits or more information contact:

Quivira Council

1555 E. 2nd

Wichita, KS 67214

Business phone: (316) 264-3386

Web: www.quivira.org

Quivira Scout Reservation

Location: QSR is located 8.5 miles north of Sedan, Kansas, on Highway 99. Turn east on county road for 2.2 miles to camp entrance.

Facilities: 475 acre lake, fishing, canoeing, backpacking, boating, swimming, hiking, rock climbing, Boy Scout “long term” camp, unit weekend camping, and council adventure programs.

Map: See map on page 57.



Will Rogers Boy Scout Reservation

Cimarron Council, Boy Scouts of America

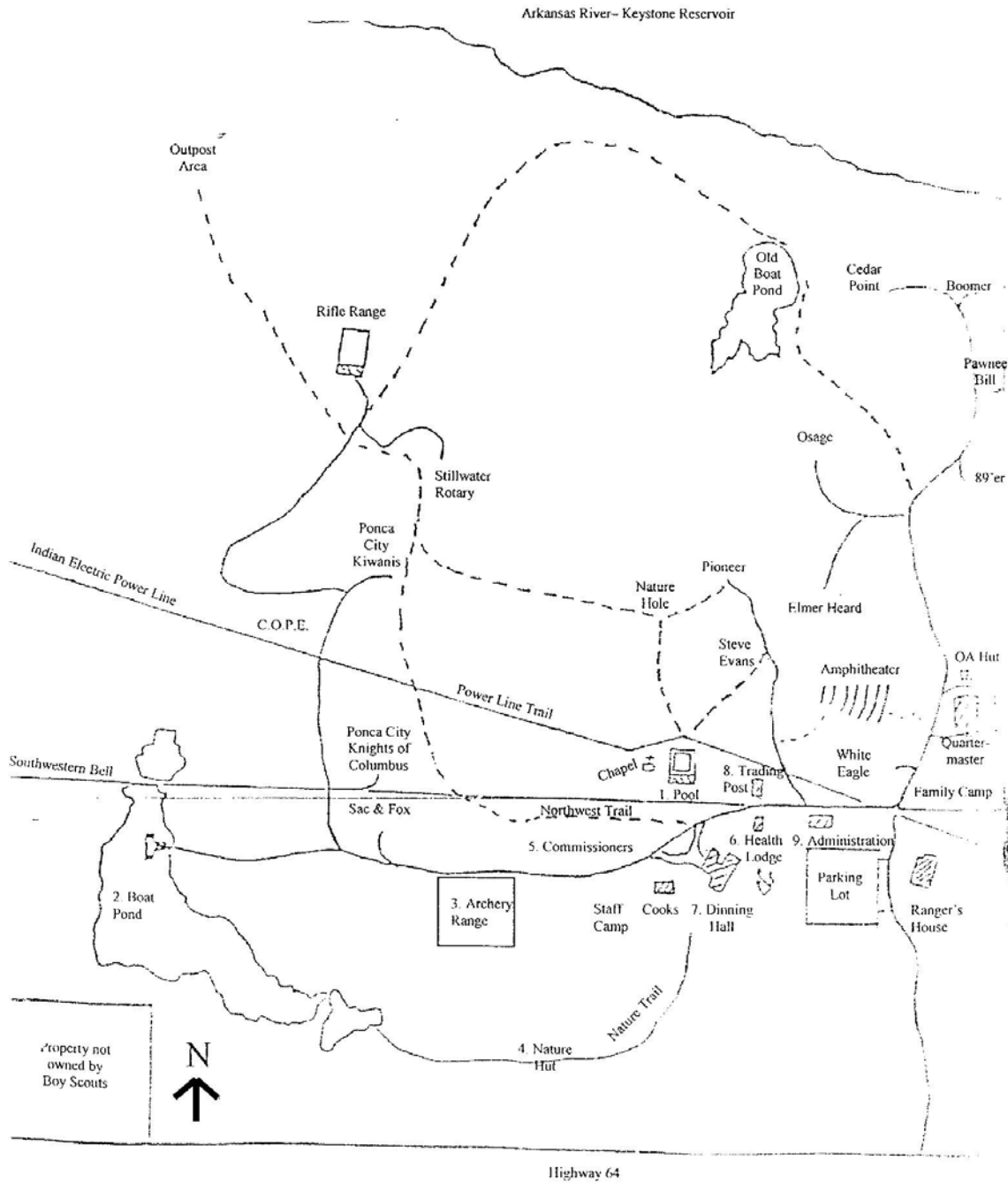

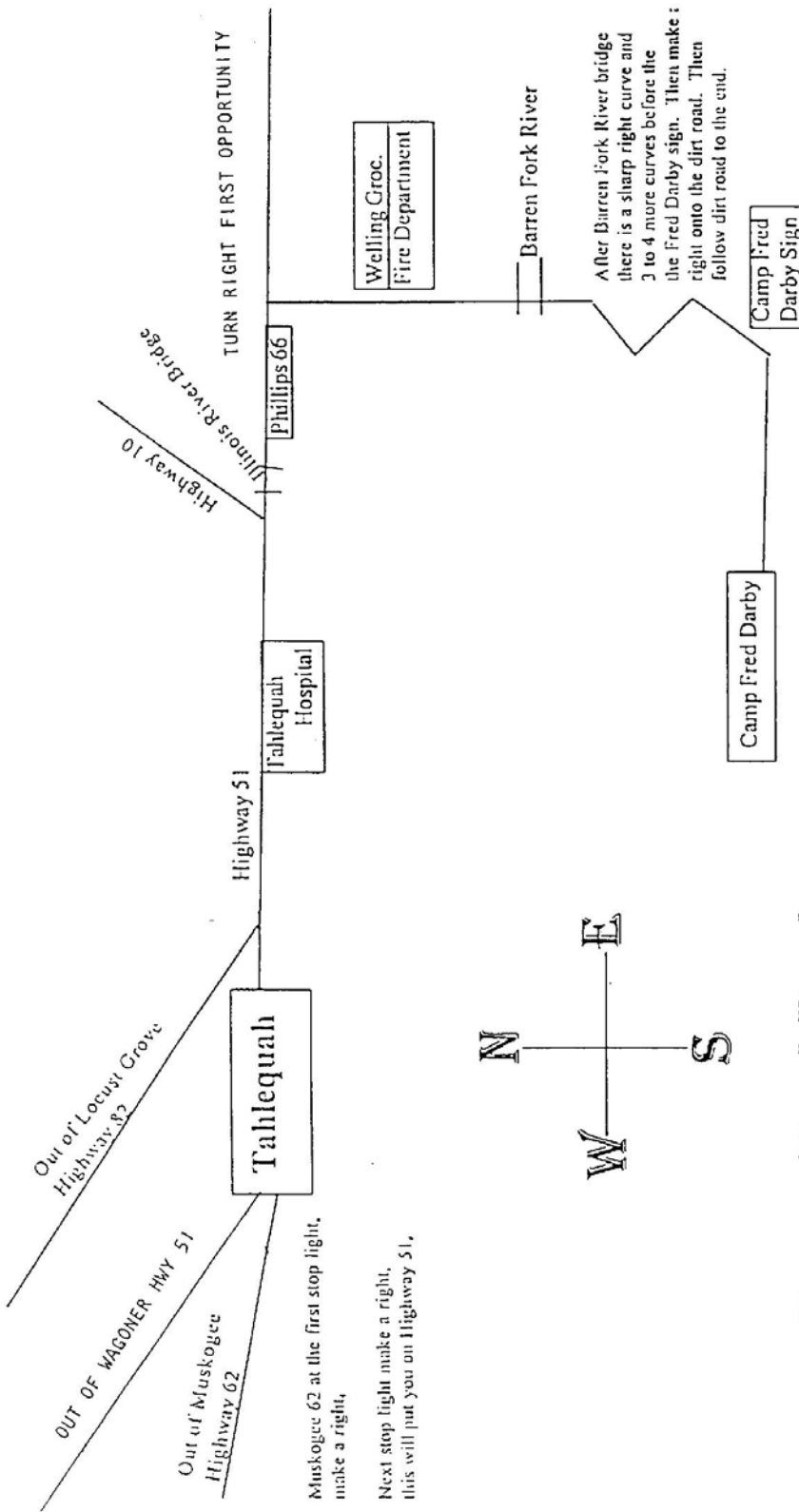

Muskogee 62 at the first stop light, make a right,

Next stop light make a right, this will put you on Highway 51,

Camp Fred Darby Indian Nations Council

Camp Garland Indian Nations Council

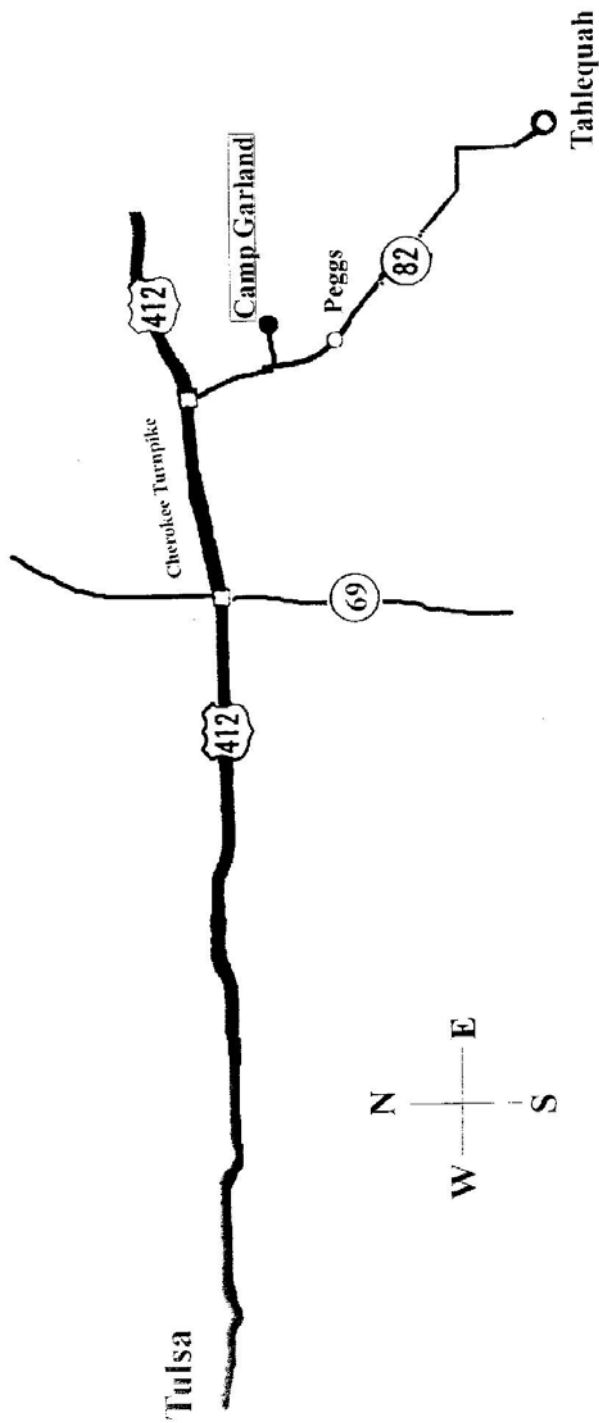

Follow Highway 412 to the Cherokee Turnpike
 Exit and follow the Cherokee Turnpike to the Highway 82 Exit
 Turn Right on Highway 82 and travel 2 miles
 Then turn left at the Camp Garland sign
 Travel .9 miles the entrance to Camp Garland will be on the right and
 the entrance to the Bartlett Training Center will be on the left

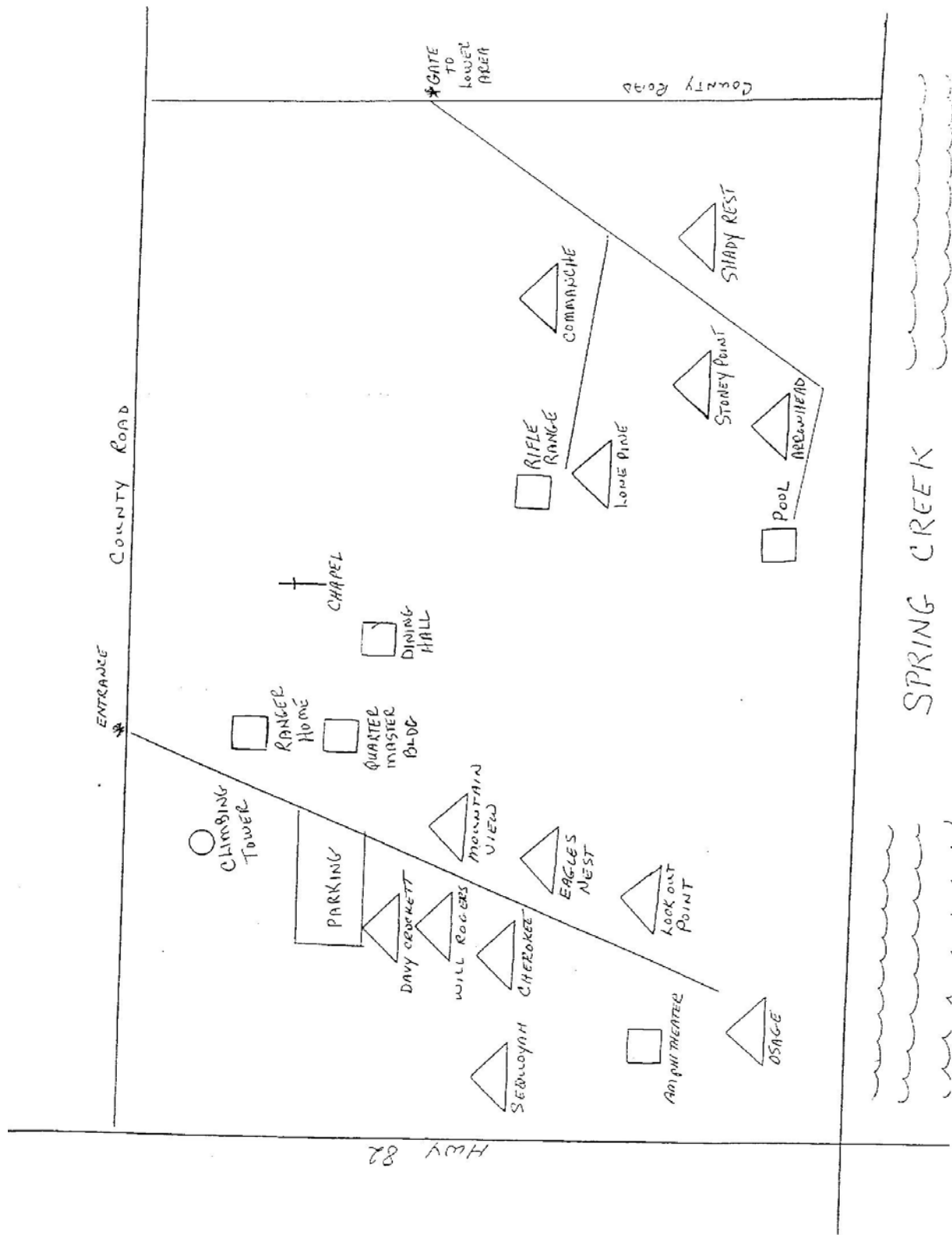

Hale Scout Reservation

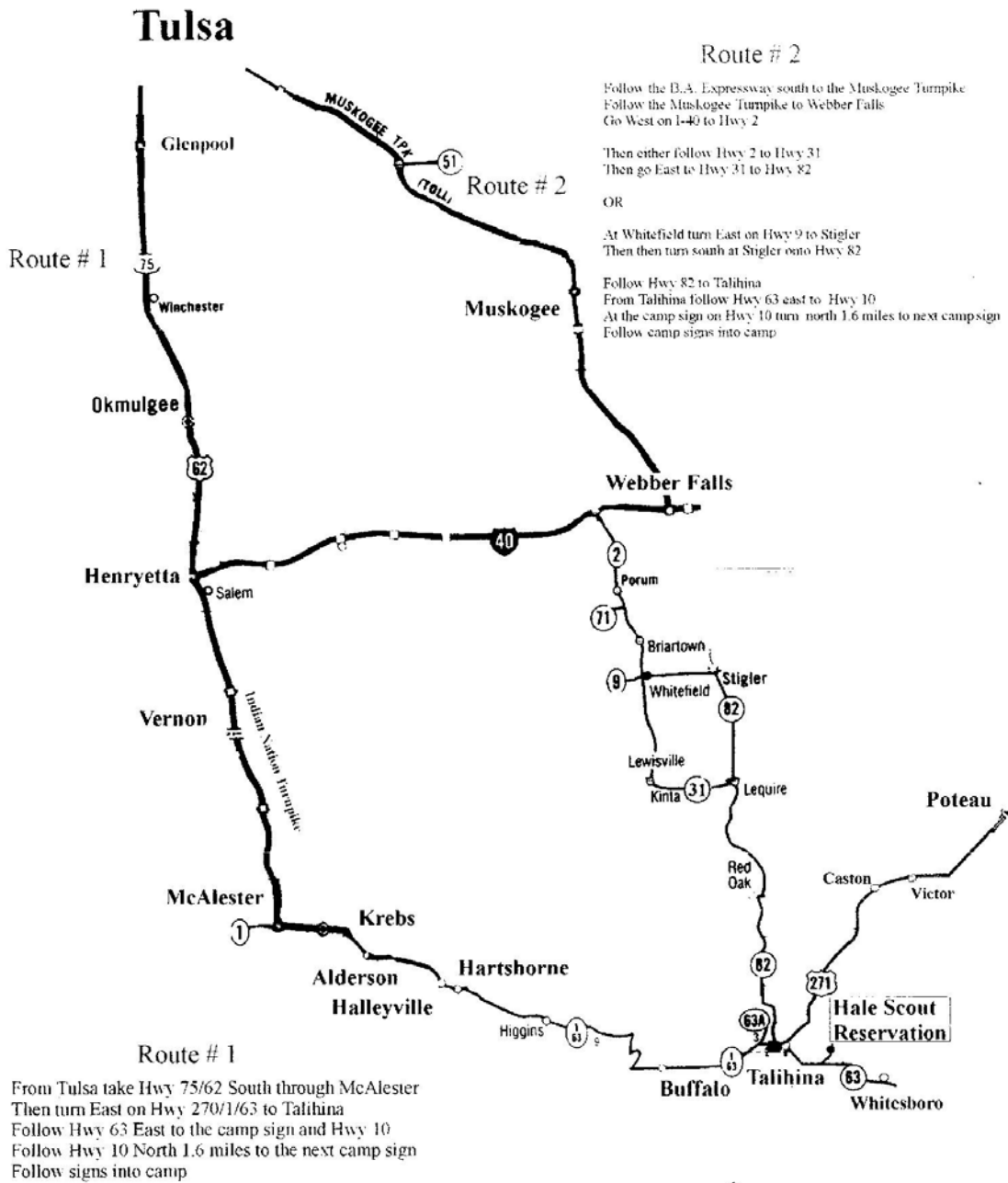

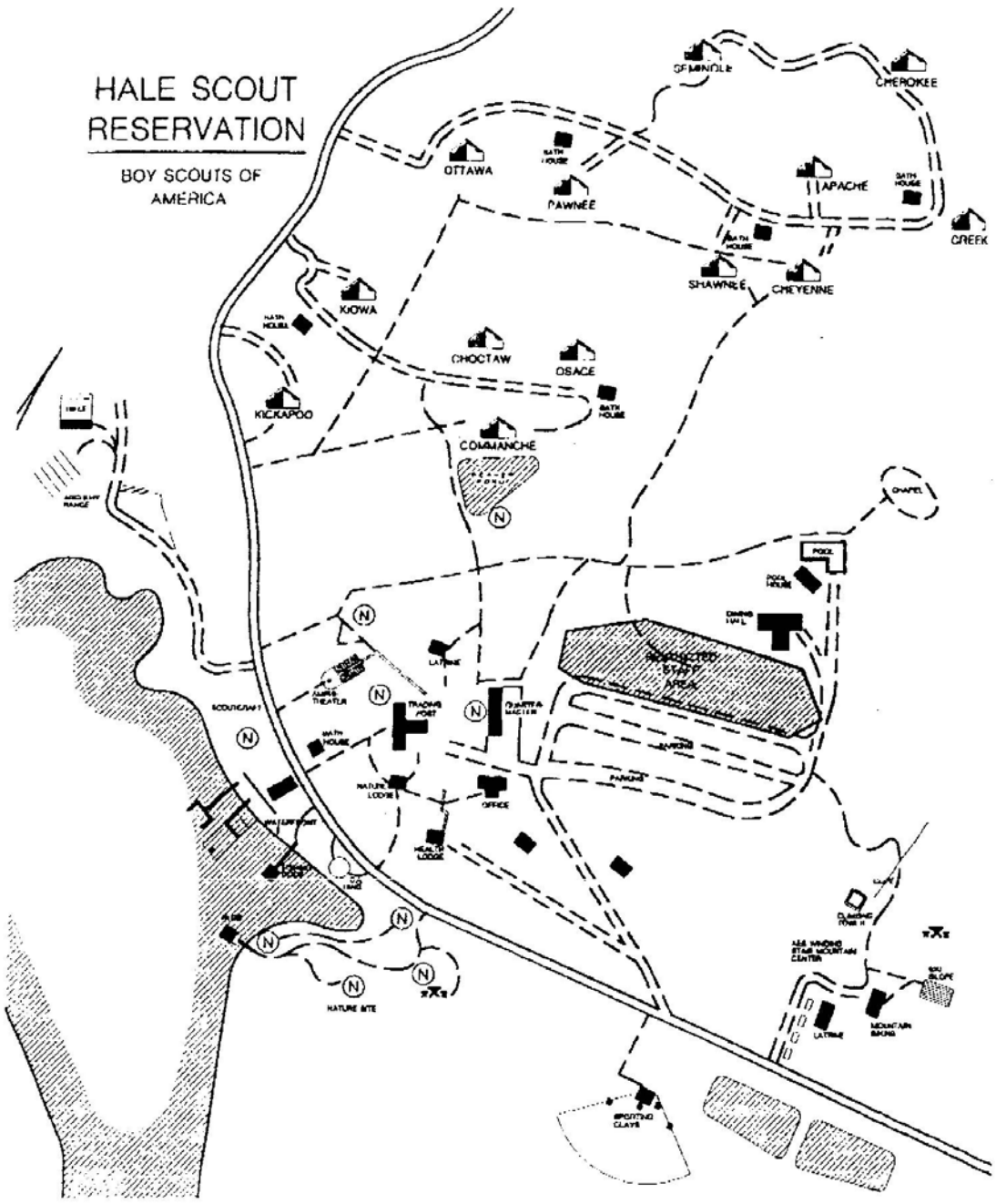

HALE SCOUT RESERVATION

BOY SCOUTS OF AMERICA

Keystone Scout Camp

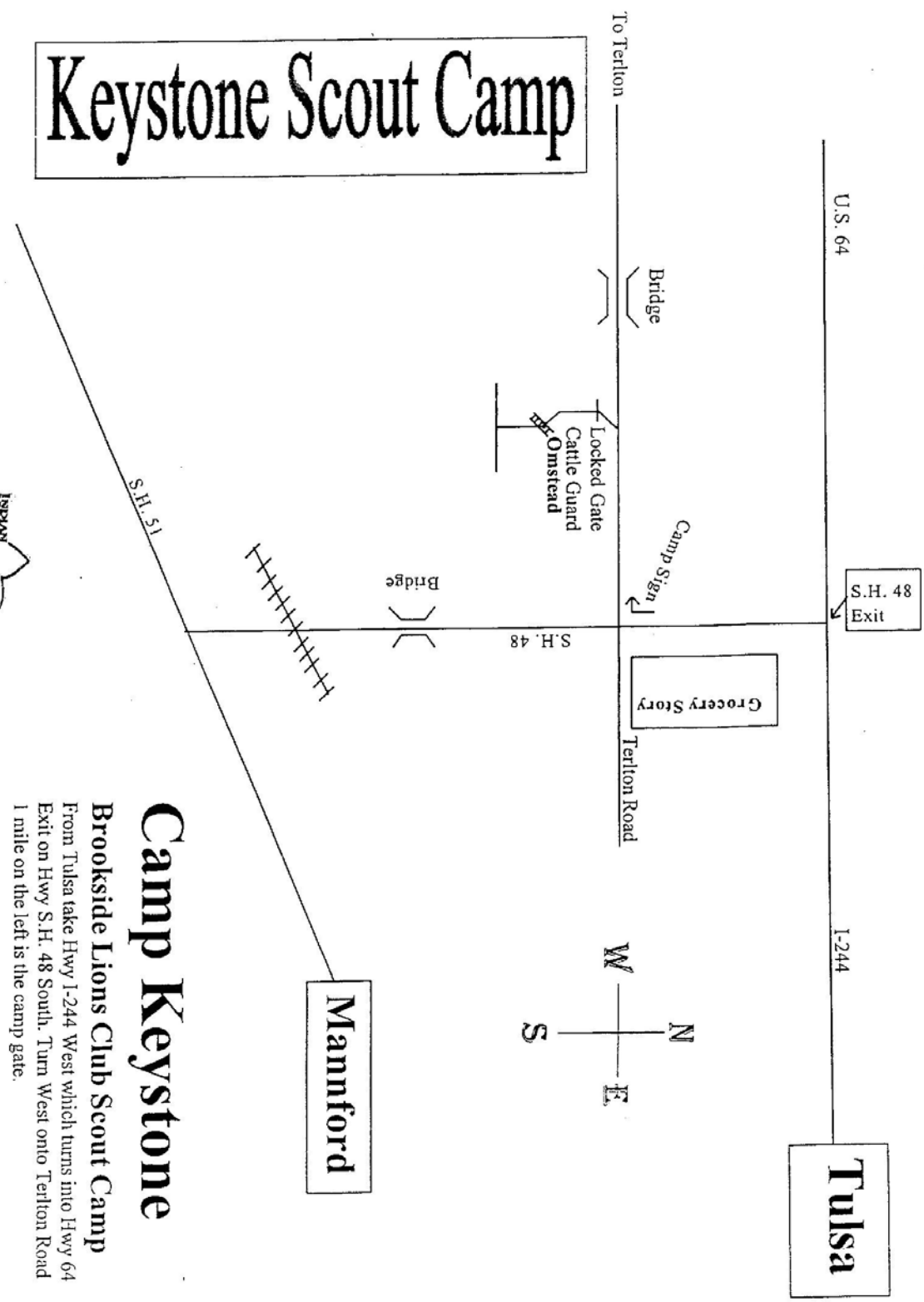

BOY SCOUTS

OF AMERICA

Camp Keystone

Brookside Lions Club Scout Camp

From Tulsa take Hwy I-244 West which turns into Hwy 64
Exit on Hwy S.H. 48 South. Turn West onto Terton Road
1 mile on the left is the camp gate.

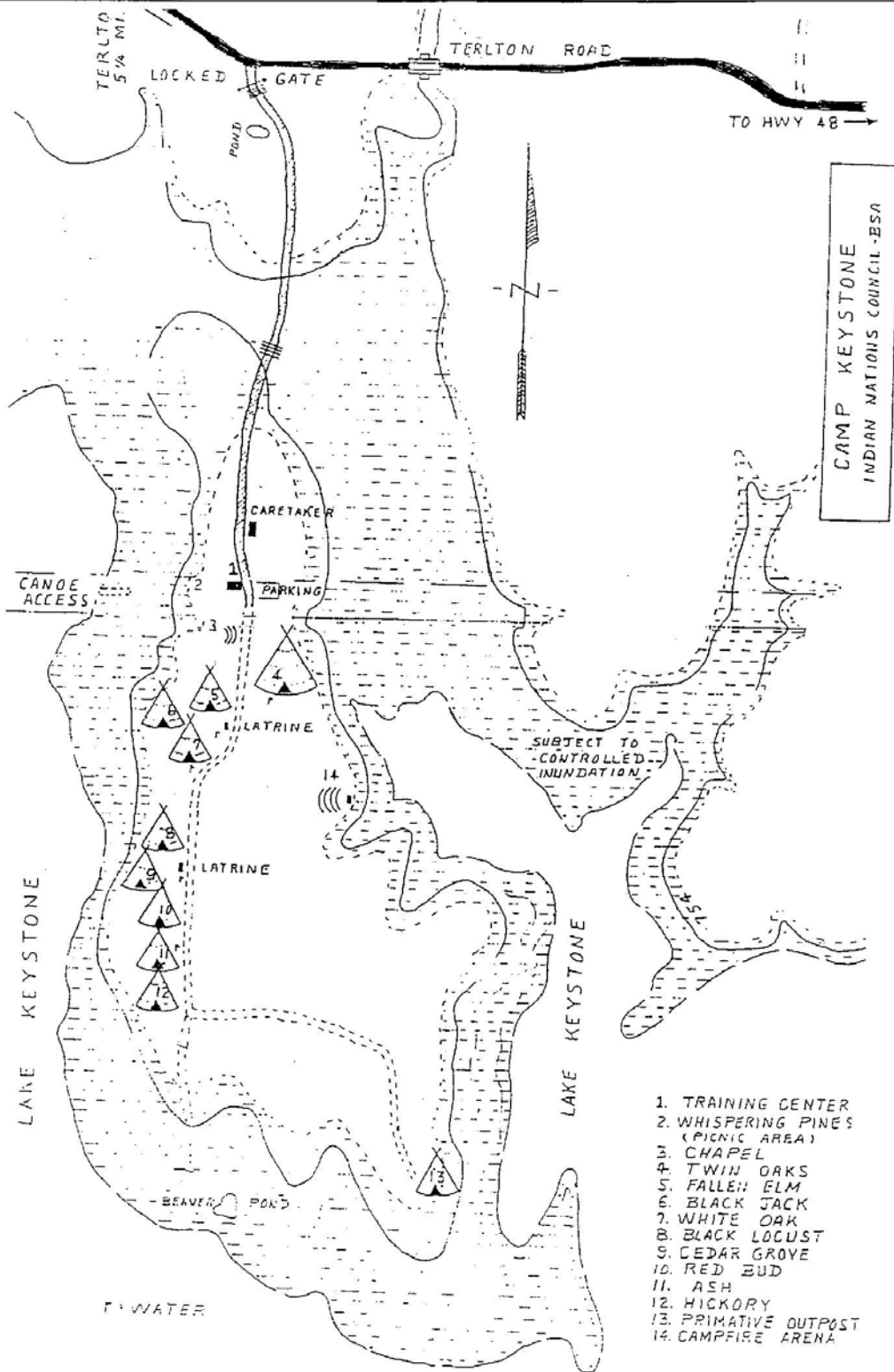

CAMP KEYSTONE
INDIAN NATIONS COUNCIL - BSA

1. TRAINING CENTER
2. WHISPERING PINES (PICNIC AREA)
3. CHAPEL
4. TWIN OAKS
5. FALLEN ELM
6. BLACK JACK
7. WHITE OAK
8. BLACK LOCUST
9. CEDAR GROVE
10. RED BUD
11. ASH
12. HICKORY
13. PRIMITIVE OUTPOST
14. CAMPFIRE ARENA

Camp Russell/ Outer Limits

Camp Russell

Located on 101st East of 193rd East Avenue (County Line Road)
 From Tulsa take the Broken Arrow Expressway East
 Exit on 71st Street
 Go East on 71st street to 193rd
 On 193rd go South to 101st Street
 One 101st Street go East about ¼ mile
 Camp Russell is on the North side of 101st Street

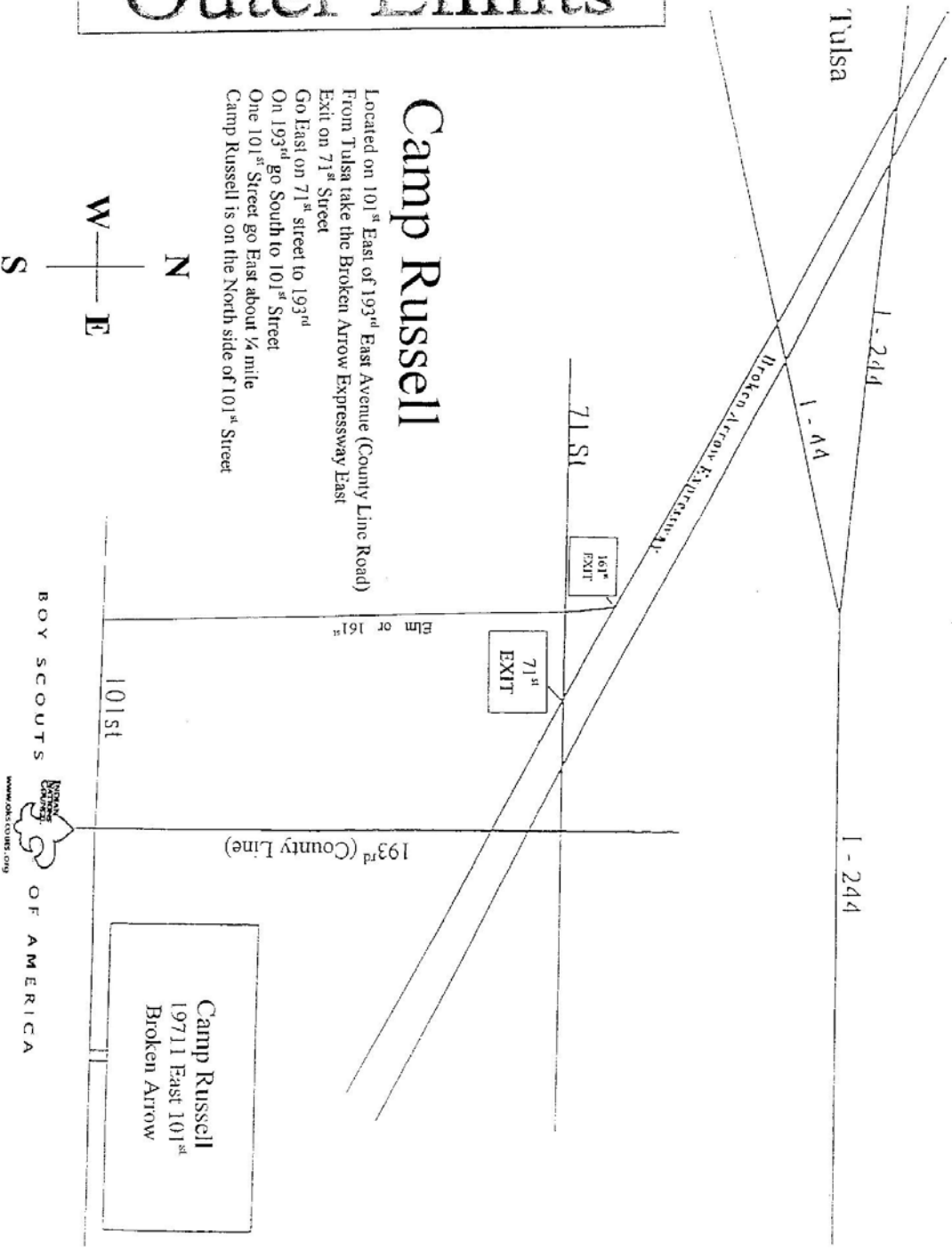
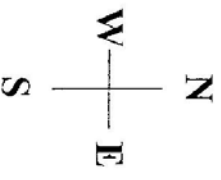

BOY SCOUTS
 OF AMERICA

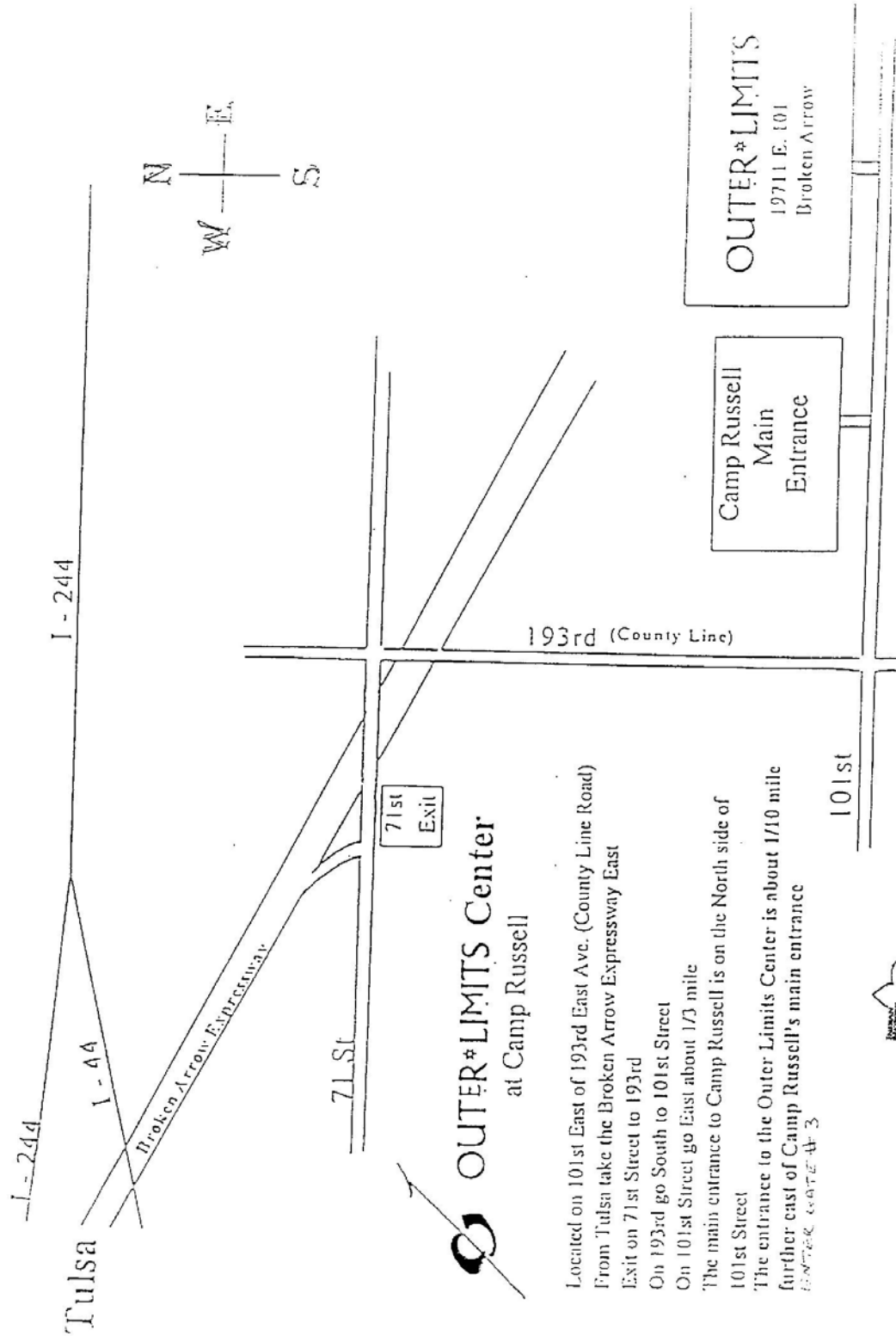

71st
Exit

 **OUTER*LIMITS Center**
at Camp Russell

Located on 101st East of 193rd East Ave. (County Line Road)
 From Tulsa take the Broken Arrow Expressway East
 Exit on 71st Street to 193rd
 On 193rd go South to 101st Street
 On 101st Street go East about 1/3 mile
 The main entrance to Camp Russell is on the North side of
 101st Street
 The entrance to the Outer Limits Center is about 1/10 mile
 further east of Camp Russell's main entrance

101st



BOY SCOUTS OF AMERICA
www.boysofamerica.org

Zink Ranch

From Tulsa take I-244 West - this Hwy turns into Hwy 64. Exit on Adams Rd. Adms Rd. will take you into Sand Springs. In Sand Springs take a right onto Hwy 97 North (McKinley Street) It is 9 miles to the Zink Ranch. At the gate you will need a gate code which is available at the Scout Service Center.

After arrival at the Ranch follow signs to:

- Aquatic Sports Center - 4 miles
- Family Enrichment Center (Cub World) - 8 miles
- Boy Scout Camping - 7 miles

Zink Scout Ranch

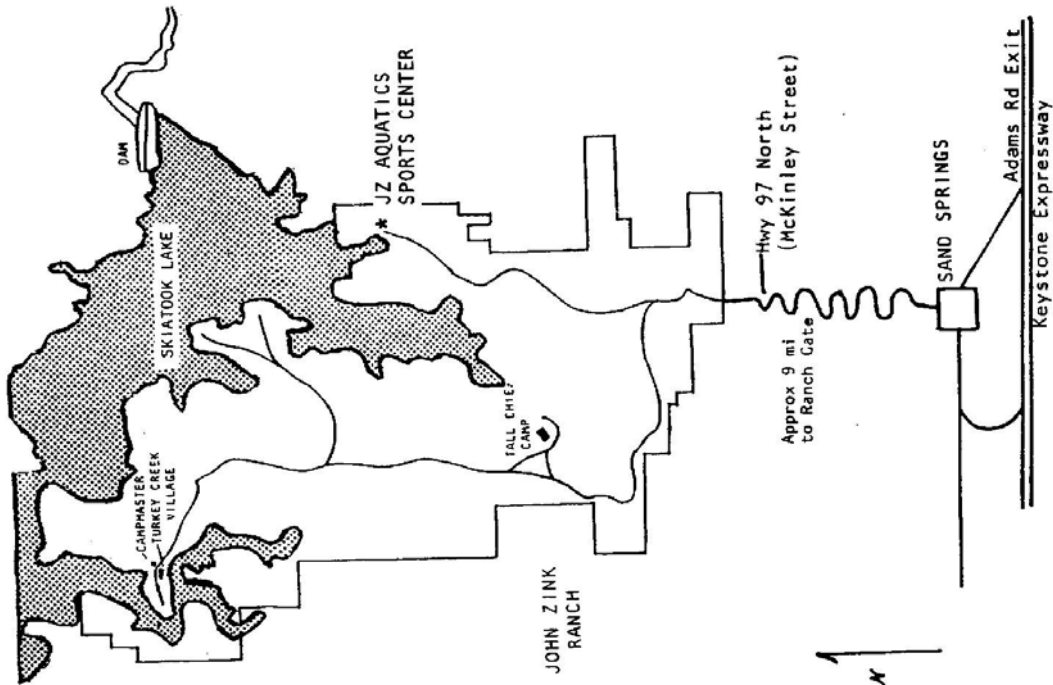
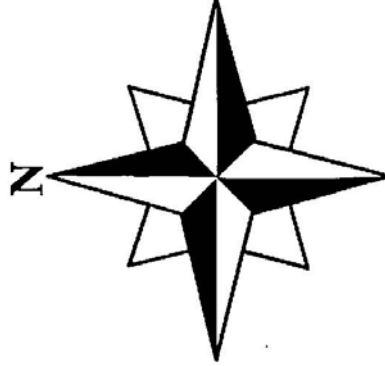

BOY SCOUTS OF AMERICA

Zink Scout Ranch

